

INKBIRD

Smoker Controller

ISC-028-BW

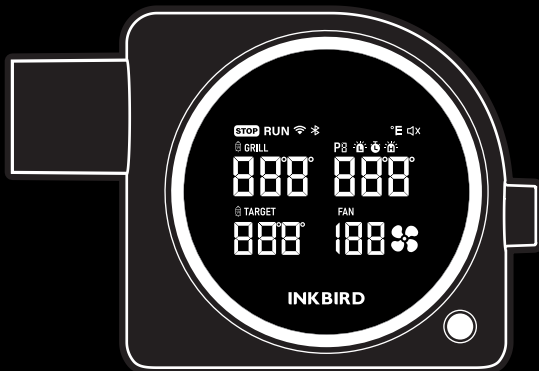

USER MANUAL



Please keep this manual properly for reference. You can also scan the QR code to visit our official website for product usage videos. For any usage issues, please feel free to contact us at **support@inkbird.com**.

- Wenn Sie eine Bedienungsanleitung in deutscher Sprache benötigen, scannen Sie bitte den QR-Code und besuchen Sie unsere Website, um sie zu erhalten und ein Video über die Verwendung des Produkts zu sehen.
- Se avete bisogno di un manuale di istruzioni in italiano, scansionate il codice QR e visitate il nostro sito web per ottenerlo e vedere un video su come utilizzare il prodotto.
- Si vous avez besoin d'un mode d'emploi en français, veuillez scanner le code QR pour visiter notre site officiel afin d'obtenir et de visionner la vidéo d'utilisation du produit !
- Als je een Nederlandstalige handleiding nodig hebt, scan dan de QR-code om naar onze officiële website te gaan en bekijk de video over het gebruik van het product!
- Si necesita el manual de instrucciones en español, escanee el código QR para ir a nuestro sitio web oficial y ver el video sobre cómo utilizar el producto.



Warm tips

- To quickly jump to a specific chapter page, click on the relevant text on the contents page.
- You can also use the thumbnail or document outline in the top left corner to quickly find a specific page.

CONTENTS

01. Overview	01
02. Technical Specifications	01
03. Product Introduction	02
04. Key Definitions	05
05. APP Installation & Connection	06
06. Main Interface of the Smoker Controller on INKBIRD App	12
07. Precautions	13
08. Troubleshooting Guide	14
09. FCC Requirement	16
10. IC Warning	17

01 Overview

The ISC-028-BW is an intelligent oven temperature controller that integrates food temperature detection and oven temperature control. It is specially designed for use in both the home and professional kitchens. It monitors the internal oven temperature in real time and intelligently adjusts the fan speed to ensure the temperature stays within the preset temperature range, achieving optimal cooking results. This device provides precise temperature control and a localized operating experience to satisfy users' requirements for high-quality cooking.

02 Technical Specifications

Input Voltage: USB Type-C, DC 5V, 1A

Short Time Measurement Range: 0°C~300°C(32°F~572°F)

Continuous Monitoring Range: 0°C~250°C(32°F~482°F)

Probe Temperature Accuracy:

±0.5°C/±0.9°F (maximum) from +25°C~+140°C(77°F~284°F)

±1.0°C/±1.8°F (maximum) from 0°C~+185°C(32°F~365°F)

±1.5°C/±2.7°F (maximum) from 0°C~+250°C(32°F~482°F)

±2.0°C/±3.6°F (maximum) from 0°C~+300°C(32°F~572°F)

Connection Methods: support Wi-Fi connection and Bluetooth connection

Wi-Fi Band: 2.4GHz & 5GHz(Support IEEE 802.11b/g/n)

Bluetooth: Bluetooth BLE5.0

Maximum Bluetooth Connection Distance: 164ft(the distance will be shorter if there are interference).

Calibration: $\pm 12^{\circ}\text{C}/^{\circ}\text{F}$

Warranty: 1 year

HVIN: ISC-028BW

03 Product Introduction

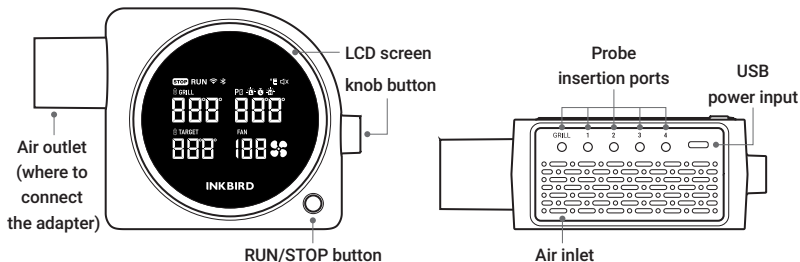

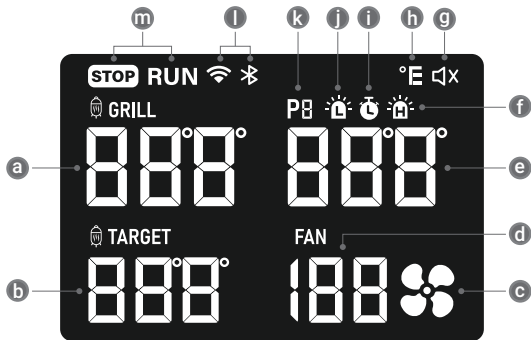

- a** Oven temperature
- b** Oven target temperature you set
- c** Fan speed state, with the current fan output value
- d** Fan output value
- e** Meat temperature
- f** High-temperature alarm from the meat probe
- g** Buzzer state (Buzzer ON / Buzzer OFF)
- h** Temperature unit
- i** Timer alarm of the meat probe
- j** Low-temperature alarm from the meat probe
- k** Meat probe number

! WiFi and Bluetooth states:

- When the WiFi icon flashes, the device is in the network pairing state;
- When the WiFi icon disappears, the device is disconnected from the network;
- When the WiFi icon stays on, the device is connected to the network.
- When the Bluetooth icon disappears, the device Bluetooth is not connected;
- When the Bluetooth icon stays on, the device Bluetooth is connected.

m Fan control operating states:

- When STOP stays on, the fan stops;
- When RUN stays on, the fan runs;
- When RUN flashes, the fan is paused.
- (With the lid-open detection function enabled, when the lid is detected to be opened, the fan automatically enters the pause state; when the lid is detected to be closed, the fan automatically enters the running state.)

04 Key Definitions



a Knob button:

- Short press it to enter the setting of target oven temperature (where you can set the target temperature of the oven only).
- Press and hold for five seconds to enter the setting of parameters (where you can set the temperature unit or other options).
- In the setting mode, turn left or right to adjust the parameter, and then short press it to confirm.
- In normal mode, the temperature of each meat probe will be displayed in turn every 2 seconds. Turn left or right to select the meat probe you want to display permanently. When the meat probe icon displays 0, the meat probes will automatically display in turn.
- **NOTE:** When you enter the setting mode and the target set value flashes, it means you can set it.

b RUN/STOP button:

- Short press it to run or stop.
- Press and hold it for 5 seconds to reset the WiFi and pair with the network again.

05 APP Installation & Connection



5.1 INKBIRD APP

Search for the INKBIRD app from Google Play or App Store to get it for free, or you can scan the QR code below to download it directly.

NOTE:

1. Your iOS devices must be running iOS 12.0 or above to download the app smoothly.
2. Your android devices must be running android 7.1 or above to download the app smoothly.
3. The device supports both 2.4GHz and 5GHz Wi-Fi routers.

5.2 Registration

- a. Registering an account is necessary before using the INKBIRD app for the first time.
- b. Open the app, select your Country/Region, and a verification code will be sent to you.
- c. Enter the verification code to confirm your identity, and the registration is complete.

5.3 WiFi Connection

Open the INKBIRD app and Click “+” on the top right corner to add a device. Then, follow the app instructions to complete the connection. Be careful to put the device as close as possible to the smartphone and router during the connection process.

5.3.1 Plug in the **ISC-028-BW**, start it up correctly. Open the INKBIRD app, click "+", and select the **ISC-028-BW** to start the connection.

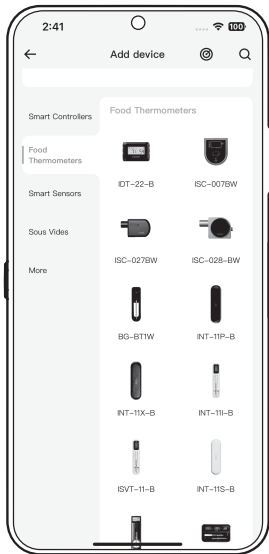

5.3.2 Select the relevant WiFi icon state and click Next Step.

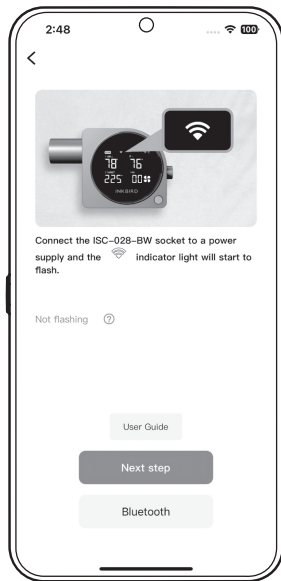

5.3.3 Select a WiFi network to connect, enter the password, and click Next Step.

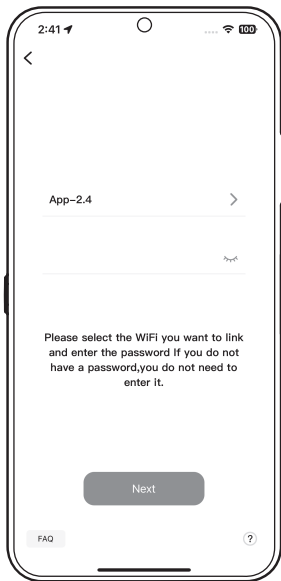

5.3.4 The phone will enter automatic pairing.

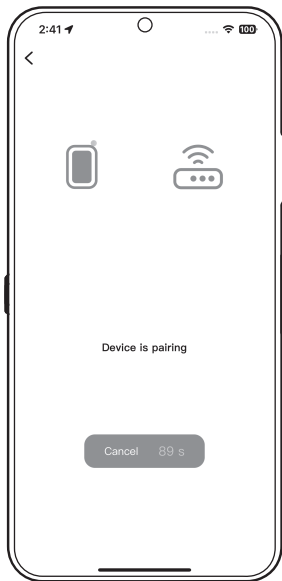

5.3.5 The pairing is successful.

NOTE: If the pairing fails, unplug the device, restart it again, and repeat the above steps to complete the connection.

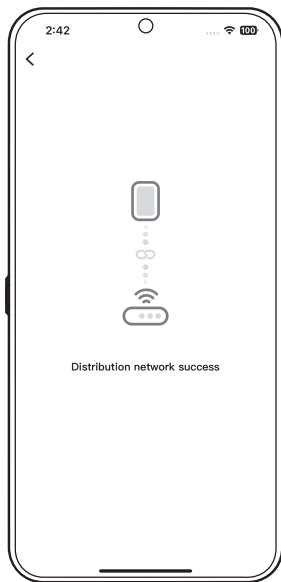

5.4 Bluetooth Connection

Once the device has connected to the app via WiFi, users can activate the Bluetooth function through the app. If no WiFi network is available, the device will automatically connect via Bluetooth instead. Users can also choose to add the device via Bluetooth in order to use it with a Bluetooth connection.

NOTE: Please turn on the GPS on your Android phone, as Google Play requires it to work properly. Once the device has been successfully paired with your phone, you won't need to pair it again unless you change phones.

06 Main Interface of the Smoker Controller on INKBIRD App

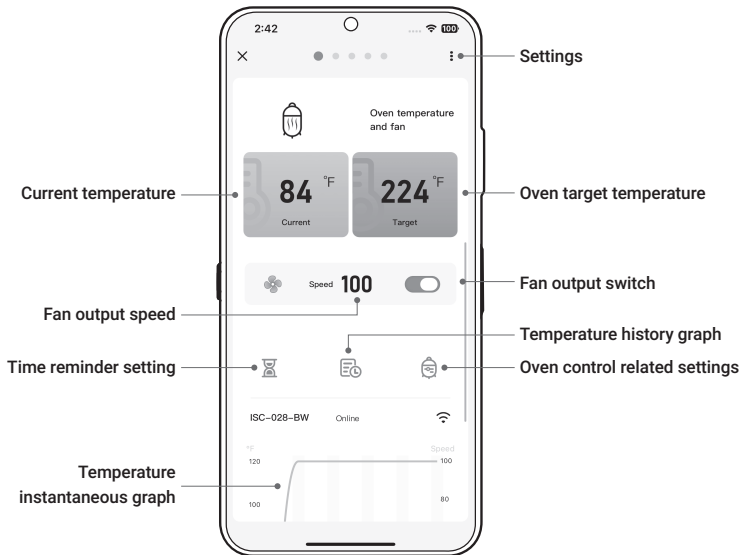

07 Precautions

- The maximum temperature for short-time measurements is 300°C/572°F and for long-time measurements is 250°C/482°F. The probe and metal wire will burn out if the temperature exceeds the maximum.
- Do not put the probes or the metal wire into a fire or allow them to come into direct contact with the heating tube.
- Do not submerge the probes or the metal wire in water, as this may lead to inaccurate measurements.
- Do not press the probes or the metal wire too hard as this may damage the plastic film on the wire and cause a short circuit.
- Please take off the silicon case before using the probe.

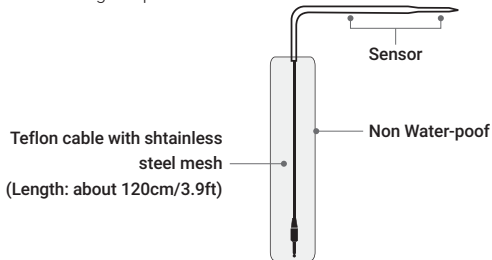

08 Troubleshooting Guide

Issues	Causes	Solutions
Can not connect to WIFI.	1.Incorrect phone settings. 2. incorrect router settings 3.incorrect connection mode selection. 4. Device malfunction.	1. Make sure that your smartphone is Bluetooth enabled and connected to the device via Bluetooth. Then, follow the app's instructions to establish a WiFi connection. 2. Please ensure that the router can transmit 2.4GHz wifi or 5Ghz WiFi signal, and the mobile phone remains connected to the wifi that can access the Internet. 3. There is no limit on the number of connected devices to the router. if you are not sure whether the upper limit has been reached, please turn off 2-3 WIFI devices. Router settings are as follows: (1) Wireless protocol: 802.11 b/g/n, but cannot be set to 1 in only. (2) Security mode: WPA/WPA2 (3) Authentication type: AES Enable DHCP service No VPN service. 4. Check that you have entered the correct WiFi name and password. 5. During the connection process, please keep the device, router and smartphone as close to each other as possible. If it still does not work, please contact customer service.

Issues	Causes	Solutions
Can't connect to Bluetooth	<ol style="list-style-type: none"> 1. Incorrect phone settings. 2. Incorrect operation 3. Device malfunction. 	<ol style="list-style-type: none"> 1. Turn on the Bluetooth and location permissions of the phone, and make sure that the permissions of app in the phone settings are all agreed. 2. The phone is not connected to other Bluetooth devices. 3. Clear the Bluetooth cache if possible. If it still does not work, please contact customer service.
inaccurate temperature reading.	<ol style="list-style-type: none"> 1. Large temperature difference in the environment. 2. The probe or probe wire is in direct contact with fire source or oven. 3. Water in the probe wire during cleaning. 	<p>Please put the probe and probe's cable (excluding the probe's plug) in a 150°C/ 302°F oven for 30 minutes, then test it with boiling water. Please hang the probes and do not let it touch the container. If it still does not work, please contact customer service.</p>
The temperature will over-shoot.	<ol style="list-style-type: none"> 1. Material of the oven is relatively heat-insulating. 2. Excessive placement of combustibles. 	<ol style="list-style-type: none"> 1. Check probe position to ensure accurate readings. 2. If the material of the oven is relatively heat-insulating, it may cause the temperature to rise faster. At this time, please lower the target temperature to allow the residual heat from the grill to heat the temperature to the target temperature. 3. If the fire is relatively large. even if the ISC-028-BW is turned

	<p>3. Inaccurat probe readings lead to calculation errors.</p>	<p>off, it may cause the temperature to continue to rise, so please be careful not to place too many coals.</p> <p>4. Some oven models have an air intake at the top, it is possible for oxygen to enter through this. Please adjust the air inlet according to the temperature</p>
--	--	---

09 FCC Requirement

Changes or modifications not expressly approved by the party responsible for compliance could void the user's authority to operate the equipment. This device complies with Part 15 of the FCC Rules. Operation is subject to the following two conditions:

- (1) this device may not cause harmful interference, and
- (2) this device must accept any interference received, including interference that may cause undesired operation.

NOTE: This equipment has been tested and found to comply with the limits for a Class B digital device, pursuant to Part 15 of the FCC Rules. These limits are designed to provide reasonable protection against harmful interference in a residential installation.

This equipment generates, uses, and can radiate radio frequency energy, and if not installed and used in accordance with the instructions, may cause harmful interference to radio

communications. However, there is no guarantee that interference will not occur in a particular installation. If this equipment does cause harmful interference to radio or television reception, which can be determined by turning the equipment off and on, the user is encouraged to try to correct the interference by one or more of the following measures:

- Reorient or relocate the receiving antenna.
- Increase the separation between the equipment and receiver.
- Connect the equipment into an outlet on a circuit different from that to which the receiver is connected.
- Consult the dealer or an experienced radio/TV technician for help.

This equipment complies with FCC radiation exposure limits set forth for an uncontrolled environment. This equipment should be installed and operated with a minimum distance of 20cm between the radiator & your body. This transmitter must not be co-located or operating in conjunction with any other antenna or transmitter.

10 IC Warning

This device contains licence-exempt transmitter(s)/receiver(s) that comply with Innovation, Science and Economic Development Canada's licence-exempt RSS(s). Operation is subject to the following two conditions:

- (1) This device may not cause interference.

(2) This device must accept any interference, including interference that may cause undesired operation of the device.

The device meets the exemption from the routine evaluation limits in issue 6 of RSS 102 and compliance with RSS-102 RF exposure, users can obtain Canadian information on RF exposure and compliance.

This transmitter must not be co-located or operating in conjunction with any other antenna or transmitter. This equipment should be installed and operated with a minimum distance of 20 centimeters between the radiator and your body.

L'émetteur/récepteur exempt de licence contenu dans le présent appareil est conforme aux CNR d'Innovation, Sciences et Développement économique Canada applicables aux appareils radio exempts de licence. L'exploitation est autorisée aux deux conditions suivantes:

L'appareil ne doit pas produire de brouillage;

L'appareil doit accepter tout brouillage radioélectrique subi, même si le brouillage est susceptible d'en compromettre le fonctionnement.

Le dispositif rencontre l'exemption des limites courantes d'évaluation dans la numéro 6 de RSS 102 et la conformité à l'exposition de RSS-102 rf, utilisateurs peut obtenir l'information canadienne sur l'exposition et la conformité de rf.

Cet émetteur ne doit pas être Co-placé ou ne fonctionnant en même temps qu'aucune autre antenne ou émetteur. Cet équipement devrait être installé et actionné avec une distance minimum de 20 centimètres entre le radiateur et votre corps.

Shenzhen Inkbird Technology Co., Ltd.

support@inkbird.com

Consignor: Shenzhen Inkbird Technology Co., Ltd.

Office Address: Room 1803, Guowei Building, No.68 Guowei Road, Xianhu Community,
Liantang, Luohu District, Shenzhen, China

Manufacturer: Shenzhen Inkbird Technology Co., Ltd.

Factory Address: 5th and 6th Floor, Building 138, No. 71, Yiqing Road, Xianhu Community,
Liantang Street, Luohu District, Shenzhen, Guangdong, China



V1.0

MADE IN CHINA
DESIGNED BY INKBIRD

