

**INKBIRD**

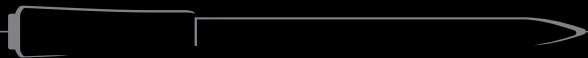

## **QUICK START GUIDE**

DUAL MODE WIRELESS BBQ THERMOMETER | INT-33-BW

The INKBIRD INT-33-BW with Bluetooth 5.4 and WiFi 5G dual-mode connectivity has been specially designed for barbecue enthusiasts. It comes with three high-precision multi-sensing probes that can be used to cook food of various sizes and types in different ways. The white probe monitors the internal temperature of food, while the black probes can monitor both the internal and environmental temperatures simultaneously. These features give you easy control over your cooking every time.

## 01 Instructions For First Use

**Warning** Before using this unit, please make sure that you have read the important safety information in this manual and that you will strictly abide by the following warnings during use.

### ● Quick Operating Guideline

- Prepare a smartphone running iOS 12 (or later) or Android 7.1 (or later) and enable both Bluetooth and WiFi on the smartphone.
- Then scan the QR code above to download the INKBIRD app. Please allow the app to obtain the location information.



1. Press and hold the red button on the right side of the device for 3 seconds to turn on the device. This device has 2 connection modes, Bluetooth 5.4 and WiFi 5G.

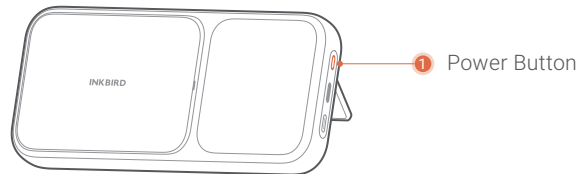

2. Click the “+” in the upper right corner of the app's home page. Then, find the INT-33-BW and follow the app's instructions to complete the connection.

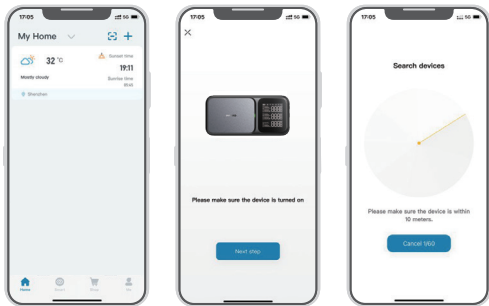

⚠ Please note that this device has the capability to automatically switch the connection mode. If you want to connect through WiFi, please ensure that the current WiFi network is stable, as the device will automatically return to Bluetooth connection if the WiFi connection fails. If you want to connect to Wi-Fi again, you can reset the Wi-Fi or remove the unit from the settings page and pair it again.

3. Take out a probe and select the corresponding probe number in the app to set the menu and doneness level. Then, insert the probe into the center of the food and make it deep enough to exceed the safe cooking line.

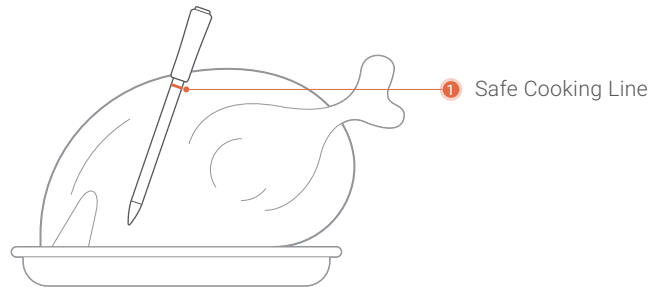

4. Once the temperature reaches the target point, both the app and thermometer will simultaneously alert you that it is time to enjoy these delicacies.

**Note** During use, make sure that the distance between the probe and the base does not exceed 6 meters (19.68 feet). If there are obstacles in between, the distance should be shortened for a stable connection.

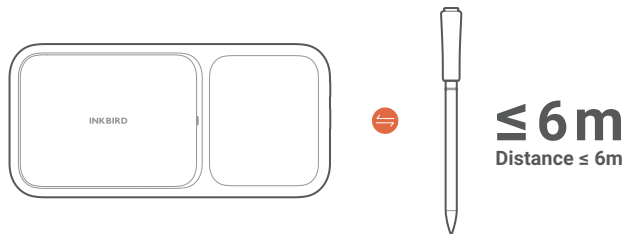

## 02 Operation Buttons Instructions



<b>Power Button</b>	Press and hold for 3 seconds to switch the device on or off.
	Press and hold for 30 seconds to reset the device.
<b>Function Button</b>	Press and hold for 3 seconds to switch the buzzer on or off.
	During cooking, press the FUNCTION button to switch to the preset temperature display and it will return to the real-time temperature display in 2 seconds.
<b>Cancel Alarms</b>	When the device is alarming, press any button to cancel the alarm.
<b>Sleep &amp; Awake</b>	By default, if there is no activity for 15 minutes, the unit automatically enters sleep mode to conserve power. Press any button to wake it up, otherwise it will shut down automatically (set the sleep function or sleep time via the app).
<b>Factory Reset</b>	Press and hold both the POWER and FUNCTION buttons simultaneously for more than 10 seconds, until the screen lights up again.

● **Indicator Light Definition**

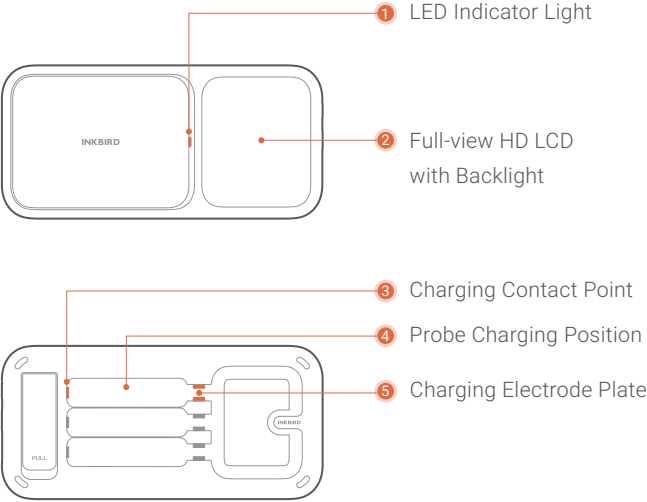

<b>Battery Level</b>	When the battery level is lower than 29%, the yellow indicator light slowly flashes 3 times.
	When the battery level is lower than 9%, the red indicator light stays on.
	When the battery is about to run out, the red indicator light will flash and then the device will switch off.
<b>Base Charging</b>	When the base is charging, the green light flashes at the respiratory rate and remains lit when fully charged.
<b>Ambient Temperature Overrun</b>	If the ambient temperature is higher or lower than the preset range, the yellow indicator light will flash until the alarm is dismissed manually or the temperature returns to the preset range.
<b>Base Overheat</b>	If the ambient temperature at which the base is placed exceeds 55°C/131°F, the red indicator light will flash quickly.

# 03 App Operation Instructions

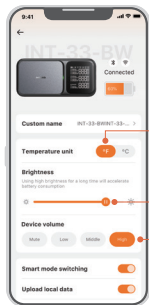

① Change Temperature Unit

② Adjust Screen Brightness

③ Adjust Sound Volume

① **Change Temperature Unit:** Go to the device settings page to change. The default unit is °F, but you can change it to °C.

② **Adjust Screen Brightness:** Go to the device settings page to find the brightness adjustment bar, which you can slide to adjust the brightness freely. The default brightness level is 80%, with a recommended minimum of 30%.

③ **Adjust Sound Volume:** Go to the device settings page to adjust the sound volume on the device. There are 4 levels to choose from: MUTE, HIGH, MEDIUM, and LOW.

④ **Temperature Calibration:** Go to the setting page of the probe that needs calibrating. Then, click the sensors to calibrate.

⚠ Each sensor can be calibrated separately. The food sensor can be calibrated from  $\pm 10^{\circ}\text{C}/\pm 18^{\circ}\text{F}$  and the ambient sensor from  $\pm 20^{\circ}\text{C}/\pm 36^{\circ}\text{F}$ .

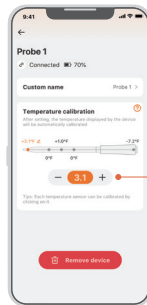

④ Temperature Calibration

## 04 Replace A Probe

**Note** If a probe needs to be replaced, make sure the device is connected to the app in Bluetooth mode. New probes cannot be paired with the device under WiFi connection.

1). Enter the device's home page and click on the probe area to enter probe setting, then select to remove the probe and confirm.

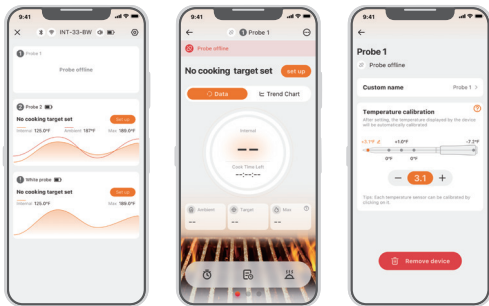

2). Return to device's home page and click the icon “⊕” in the probe area to start pairing.

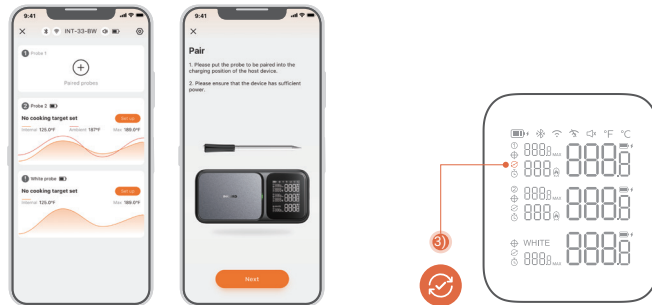

3). Follow the app's instructions and place the unpaired new probe on the charging position of the base to start charging, at this point, the device will beep once and display the icon “⌚” on the screen. Once the device has successfully paired with the new probe, you may proceed to use it.

# 05 Functions Detailed Introduction

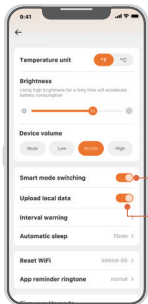

**① Smart Mode Switching:** The device will automatically identify whether it is currently in a WiFi environment and whether the WiFi signal, quality, and availability are good enough to maintain consistent temperature monitoring and a stable connection with your smartphone. Once the WiFi becomes unstable, the device will

automatically switch to Bluetooth connection. If you want to disable this function, simply go to the device setting page within the app and find the Smart Mode Switching option to disable the function.

**② Local Data Storage:** The device can store up to 120 min of cooking data, which will be automatically uploaded to the app once a connection has been established. In the event of a brief disconnection due to operational error, no data will be lost.

**③ Auto Sleep & Shutdown:** After powering on, the device will automatically sleep and enter a low power consumption mode if it is left unused for 15 minutes. To wake it up, press any button on the base. If the device is not activated within 10 minutes of entering sleep mode, it will automatically power off to conserve power.