

INKBIRD

IDT-34c-B

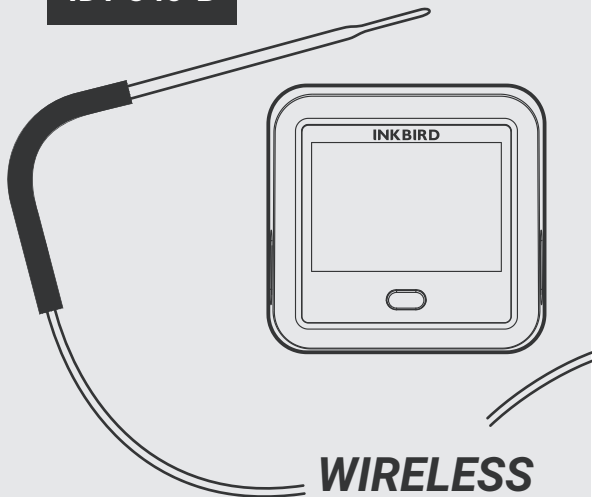

**WIRELESS
BBQ
THERMOMETER**

USER MANUAL



Warm tips

- To quickly jump to a specific chapter page, click on the relevant text on the contents page.
- You can also use the thumbnail or document outline in the top left corner to quickly find a specific page.

CONTENTS

01	<i>Overview</i>	01
02	<i>Technical Specifications</i>	02
03	<i>Product Diagram</i>	03
04	<i>Key Definitions</i>	04
05	<i>Battery Installation & Precautions</i>	04
06	<i>Quickstart Guide</i>	05
07	<i>APP Installation & Connection</i>	07
08	<i>Cleaning and Maintenance</i>	10
09	<i>Troubleshooting Guide</i>	10
10	<i>FCC Requirement</i>	12
11	<i>IC Warning</i>	13
12	<i>Customer Service</i>	14



Please keep this manual properly for reference. You can also scan the QR code to visit our official website for product usage videos. For any usage issues, please feel free to contact us at **support@inkbird.com**.



IMPORTANT NOTES/WARNINGS

1. Keep children away to prevent them from being hurt by sharp probes.
2. This product is not suitable for use in microwaves and pressure cookers.
3. Do not expose this product to high temperatures, such as hanging/-placing it on a hot surface of a hearth, oven, or grill, or placing it inside the oven or grill.
4. Do not expose the probes directly to fire or burning charcoal, or use them in an environment other than -22°F~572°F. Otherwise, the probe and probe cord will be damaged.
5. Do not touch the probe or probe cord with your hands during/at the end of cooking. Wear heat-insulation gloves if necessary to avoid burns.
6. Do not immerse the probe in water, put it in the dishwasher, or use corrosive detergents to clean it. Rinse under running water and dry for storage.
7. This thermometer is not waterproof. Be careful not use it in high-humidity environments such as bathrooms and gardens. Otherwise, it will be damaged.
8. When it is necessary to replace the batteries, please be sure to choose high-quality alkaline batteries and safely dispose of the original batteries. When the power is insufficient, the temperature measured by the thermometer may be inaccurate or unusable.

- **Reference Table for Minimum Internal Temperature of Food Safety (USDA Database)**

Food	Type	Internal Temperature (°F)
<i>Beef,bison,veal, goat,and lamb</i>	<i>Steaks, roasts, chops</i>	145 <i>Rest time: 3 minutes</i>
	<i>Ground meat and sausage</i>	160
<i>Casseroles</i>	<i>Meat and meatless</i>	165
<i>Chicken,turkey, and other poultry</i>	<i>All: whole bird, breasts, legs, thighs, wings, ground poultry, giblets, sausage, and stuffing inside poultry</i>	165
<i>Eggs</i>	<i>Raw eggs</i>	<i>Cook until yolk and white are firm</i>
	<i>Egg dishes (such as frittata quiche)</i>	160
	<i>Casseroles (contain- ing meat and poultry)</i>	165
<i>Ham</i>	<i>Raw ham</i>	145 <i>Rest time: 3 minutes</i>
	<i>Precooked ham (to reheat)</i>	165 <i>Note: Reheat cooked hams packaged in USDA-inspected plants to 140°F</i>
<i>Leftovers</i>	<i>Any type</i>	165

Food	Type	Internal Temperature (°F)
<i>Pork</i>	<i>Steaks, roasts, chops</i>	145 <i>Rest time: 3 minutes</i>
	<i>Ground meat and sausage</i>	160
<i>Rabbit and venison</i>	<i>Wild or farm-raised</i>	160
<i>Seafood</i>	<i>Fish (whole or filet) such as salmon, tuna, tilapia, pollock bass, cod, catfish, trout, etc</i>	145 or cook until flesh is no longer translucent and separates easily with a fork
	<i>Shrimp, lobster, crab, and scallops</i>	Cook until flesh is pearly or white, and opaque
	<i>Clams, oysters, mussels</i>	Cook until shells open during cooking

01 Overview

INKBIRD IDT-34c-B, a smart wireless BBQ thermometer, uses Bluetooth 5.1 to help you accurately measure the internal temperature of the food when grilling or cooking, reducing the waste of energy and food resources and preventing foodborne diseases. You can set the desired temperature and food doneness through the mobile application and remotely monitor the changes in food status through the phone. When the cooking is done, this smart thermometer will remind you that it is time to enjoy these delicious foods.

02 Technical Specifications

Model Number	IDT-34c-B
Bluetooth Version	BLE 5.1
Bluetooth Connection Distance	260ft/80m (without obstacles; for reference only)
Screen Type	HD Backlit LCD
Screen Size	57*36mm
Probe Number	4
Probe Jack Size	φ2.5mm; length 11mm
Probe Sensor Type	NTC
Temperature Measurement Accuracy	±1°C/±1.8°F
Temperature Measurement Range	-30~300°C /-22~572°F (Short-Time Measurement) -20~250°C/-4~482°F (Continuous Monitoring)
Probe Cord Length	1.2m/3.9ft
Temperature Calibration Range	±7°C (±12.6°F)
Temperature Refreshing Time	< 1s
Power Source	2 AA Batteries
Dimension	86*83*38.5mm
Weight	110g
Package Contents	Thermometer*1 (IDT-34c-B) Probes Probe Clamps AA Batteries*2 User Manual*1

03 Product Diagram

HD Backlit LCD Screen

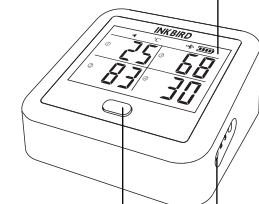

Power Button

Probe Ports (3-4)

Battery Compartment

Hanging Hole

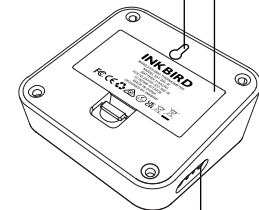

Probe Ports (1-2)

• Screen Display Description

Log	<i>Temperature is being logged.</i>
★	<i>Backlight is turned on.</i>
🔊 ×	<i>Mute mode.</i>
🔊	<i>Alarm mode.</i>
📶 flashes	<i>Bluetooth is pairing.</i>
📶 remains on	<i>Bluetooth is connected.</i>
📶 disappears	<i>Bluetooth connection is disconnected.</i>
🔋	<i>Device battery level.</i>
🔋 flashes	<i>The device is low on power. Replace the batteries immediately.</i>
°F/°C	<i>Temperature unit.</i>
H flashes	<i>Remind you when the current temperature is detected to exceed the preset temperature.</i>
L flashes	<i>Remind you when the current temperature is detected to be lower than the preset temperature.</i>
🕒	<i>Set a timer.</i>
🕒 flashes	<i>Alarm when the timer reaches.</i>

04 Key Definitions

- ① Power ON/OFF: Press and hold the power button for 3 seconds to turn on/off the device.
- ② When Bluetooth requests pairing, press the button to complete the pairing and connect.
- ③ Cancel Alarm: When the temperature alarm is triggered, press the button to cancel the alarm.
- ④ Low Battery: When the low battery prompt is triggered (the battery power is $\leq 10\%$), press the button to cancel the reminder.
- ⑤ Force Restart (reset) : Remove the battery to reset the device.

05 Battery Installation & Precautions

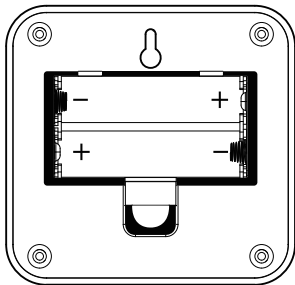

- ① Open the battery compartment.
- ② Pay attention to the battery polarity and correctly install two new AA alkaline batteries.
- ③ Cover the battery compartment and press and hold the power button for 3 seconds to turn on the thermometer.

• Precautions For Use

- ① Use two new alkaline batteries. Do not mix old and new, do not use rechargeable batteries, and do not use standard carbon-zinc batteries.
- ② Correctly install the batteries and turn on the device. After the probe is inserted into the probe port, the part of the screen corresponding to the channel will display the current temperature.
- ③ Insert the probe tip into the middle of the food to measure the internal temperature of the food.
- ④ To perform parameter settings for the thermometer, select food menus, temperatures, and doneness levels, or monitor temperature changes, you should download and open the INKBIRD APP on your phone and connect it via Bluetooth.
- ⑤ This device is suitable for continuous monitoring of food cooking progress. During cooking, please ensure that the probe is inserted into the food and does not remove it. The internal temperature of the food will be displayed in the corresponding area of the thermometer screen.

06 *Quickstart Guide*

Before using your Bluetooth smart thermometer IDT-34c-B, please ensure that the device has two new AA alkaline batteries installed and that you have read the Important Safety Information in this manual.

- 1) When cleaning the stainless steel temperature probe included in the product packaging, please be careful not to immerse the probe or wire in water or use corrosive cleaners as the probe may be damaged.
- 2) Prepare a smartphone running iOS 12 (or higher) or Android 7.1 (or higher), download the INKBIRD APP, and complete the connection. (Please refer to section 7. APP Installation & Connection in this Manual)
- 3) Insert the cleaned probe into the probe channels of the thermometer in sequence, and the screen will display the real-time temperatures corresponding to the probes.
- 4) Open the APP and set the parameters for the food to cook.
- 5) Insert the probe into the center of the meat, avoiding nearby bones or cartilage. Be careful not to twist the probe wire, and keep the probe away from flames during cooking. You can use a probe clamp to secure the probe during cooking for stable and reliable measurements.
- 6) If you will use an oven, place the thermometer on a non-metallic and non-heated flat surface outside the oven and leave enough slack for the probe wire to prevent the probe from leaving the food during the closing of the oven door or from being connected loosely to the thermometer.
- 7) When the internal temperature of the food reaches the set temperature, the thermometer will sound a sound alarm, and the APP will also send an alarm notification. To stop the alarm, you can press the button on the thermometer once or operate the APP to stop it. If you do not perform any operation, the alarm will not stop.

Note: After cooking, do not touch hot probes or wires immediately, and wear enough heat-insulating gloves or tools if necessary to prevent burns.

07 *APP Installation & Connection*



7.1 INKBIRD APP

Search the INKBIRD App from Google Play or App Store to get it for free, or you can scan the QR code to download it directly.

NOTE:

1. Your iOS devices must be running iOS 12.0 or above to download the app smoothly.
2. Your android devices must be running android 7.1 or above to download the app smoothly.
3. APP Location Permission Requirement: We need to obtain your location information to discover and add nearby devices. INKBIRD promises to keep your location information strictly confidential. And your location information will only be used for the location function of the App and will not be collected, used, or disclosed to any third party. Your privacy is very important to us. We will abide by relevant laws and regulations and take reasonable security measures to protect your information security.

7.2 Registration

Step1: Registering an account is necessary before using the INKBIRD app for the first time.

Step2: Open the app, select your Country/Region, and a verification code will be sent to you.

Step3: Enter the verification code to confirm your identity, and the registration is complete.

7.3 How to Connect

7.3.1 Open the INKBIRD app and Click “+” on the top right corner to add a device. Then, follow the app instructions to complete the bluetooth connection.

NOTES:

- ① Before starting the Bluetooth connection of the device, please ensure that your phone has been properly installed with the INKBIRD APP, enabled location, and allowed the INKBIRD APP to access location information.
- ② When using the Bluetooth connection, keep your phone as close as possible to the device. If the distance between the phone and the device is too long or there are obstacles or blockers, the signal will weaken or even break off the connection.
- ③ After successfully connecting the phone to the device, if you place the temperature sensor next to a metal table or object, the signal will weaken or even break off the connection. Please keep the device away from metal and keep the temperature sensor at least 1 m away from the ground.
- ④ Please note that Bluetooth will always be on after the device is turned on, and only when the device is turned off will the Bluetooth be turned off.

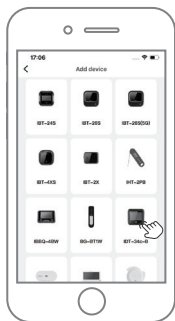

Add a device



Next step

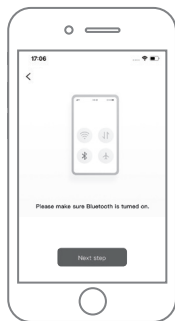

Next step



Bluetooth connection



Press the panel button



The pairing is complete

08 *Cleaning and Maintenance*

- ① Do not immerse the thermometer and probe in water or clean it in the dishwasher.
- ② Please avoid using aggressive detergents to clean the thermometer. Use only running water and clean with a dry towel. If necessary, wipe the thermometer with a damp towel, but avoid letting the probe jack get wet.
- ③ Avoid exposing the thermometer to high temperatures while in use. Do not place the thermometer on high-temperature devices such as ovens, broilers, or grills, as this may damage the product.
- ④ Do not use or store the device in extreme weather conditions or highly damp environments. It may cause property damage or injury to the user.
- ⑤ The product is suitable for grilling and cooking. We do not recommend using it for other purposes.
- ⑥ When you do not intend to use this device for a long time, we recommend removing the battery and closing the battery compartment.
- ⑦ Store the thermometer and probes in a cool, dry place away from children.

09 *Troubleshooting Guide*

What can you do if the device is not working? Here are some possible reasons and relative solutions for reference. We hope they are helpful. For any further questions, please feel free to contact us at support@inkbird.com.

Issues	Possible Solutions
Not Connected	<ol style="list-style-type: none"> 1) Make sure Bluetooth is enabled on your phone or tablet. 2) Check that your phone has location services enabled and the application has permission to use location. 3) Position your phone or tablet as close as possible to the thermometer, and we recommend keeping it away from metals or obstacles. 4) Ensure the device is disconnected from other smartphones, and close the Bluetooth feature on these phones. 5) Restart the device and open the applications again. 6) Confirm that your phone or tablet is running an operating system version of iOS 12/Android 7.1 or higher. 7) Remove the battery to reset the device. 8) Close other Bluetooth devices within the connection range or disable their Bluetooth feature.
Disconnect After Connection	<ol style="list-style-type: none"> 1) Please position your phone as close as possible to the device. If the distance between your phone and the thermometer is too long or there are many obstacles, the signal may weaken or break off the connection. 2) When using a Bluetooth connection, please do not place the thermometer near metal objects and keep the thermometer at least 1m away from the ground. Otherwise, the signal may weaken or even break off the connection. 3) Please ensure that you have not disabled the location service feature on your phone or tablet or denied the location permission for the INKBIRD app during the operation of the thermometer.

10 *FCC Requirement*

Changes or modifications not expressly approved by the party responsible for compliance could void the user's authority to operate the equipment. This device complies with Part 15 of the FCC Rules. Operation is subject to the following two conditions:

- (1) this device may not cause harmful interference, and
- (2) this device must accept any interference received, including interference that may cause undesired operation.

Note: This equipment has been tested and found to comply with the limits for a Class B digital device, pursuant to Part 15 of the FCC Rules. These limits are designed to provide reasonable protection against harmful interference in a residential installation. This equipment generates, uses, and can radiate radio frequency energy, and if not installed and used in accordance with the instructions, may cause harmful interference to radio communications. However, there is no guarantee that interference will not occur in a particular installation. If this equipment does cause harmful interference to radio or television reception, which can be determined by turning the equipment off and on, the user is encouraged to try to correct the interference by one or more of the following measures:

- Reorient or relocate the receiving antenna.
- Increase the separation between the equipment and receiver.
- Connect the equipment into an outlet on a circuit different from that to which the receiver is connected.
- Consult the dealer or an experienced radio/TV technician for help.

This equipment complies with FCC radiation exposure limits set forth for an uncontrolled environment.

11 *IC Warning*

This device contains licence-exempt transmitter(s)/receiver(s) that comply with Innovation, Science and Economic Development Canada's licence-exempt RSS(s). Operation is subject to the following two conditions:

- (1) This device may not cause interference.
- (2) This device must accept any interference, including interference that may cause undesired operation of the device.

L'émetteur/récepteur exempt de licence contenu dans le présent appareil est conforme aux CNR d'Innovation, Sciences et Développement économique Canada applicables aux appareils radio exempts de licence. L'exploitation est autorisée aux deux conditions suivantes :

- 1) L'appareil ne doit pas produire de brouillage;
- 2) L'appareil doit accepter tout brouillage radioélectrique subi, même si le brouillage est susceptible d'en compromettre le fonctionnement.

12 *Customer Service*

This item carries a 1-year warranty against defects in either components or workmanship. During this period, products that prove to be defective will, at the discretion of INKBIRD, be either repaired or replaced without charge. For any problems in use, please feel free to contact us at support@inkbird.com. We will do our best to help you.

INKBIRD TECH.C.L.

support@inkbird.com

Factory address: 6th Floor, Building 713, Pengji Liantang Industrial Area, NO.2 Pengxing Road, Luohu District, Shenzhen, China

Office address: Room 1803, Guowei Building, NO.68 Guowei Road, Xianhu Community, Liantang, Luohu District, Shenzhen, China



V3.0